

# BATRIC – G27

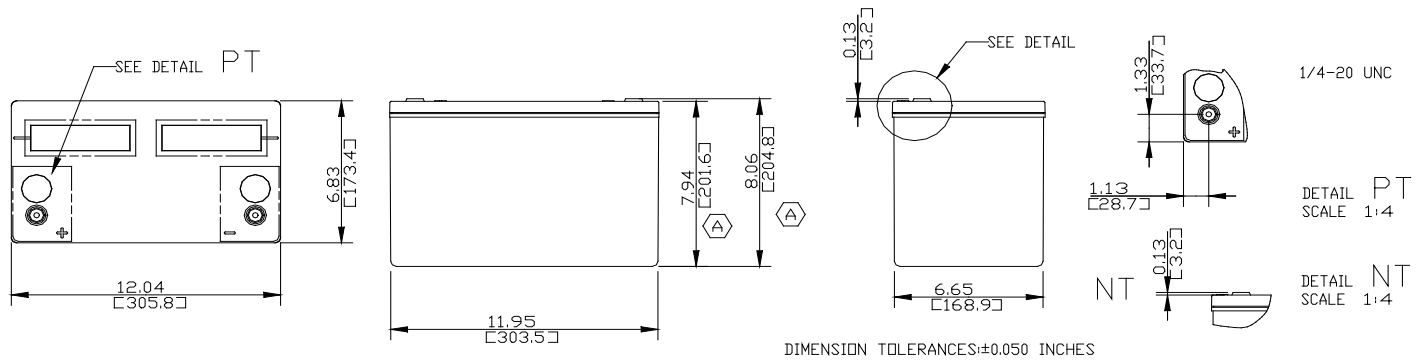

DIMENSION TOLERANCES:±0.050 INCHES

## BATRIC - G27 - Specifications

\*All dimensions inches and (millimeters). All dimensions are for reference only

Cells Per Unit	Voltage Per Unit	Max. Weight	Electrolyte	Maximum Discharge Current	Short Circuit Current	10Sec. Volts @100 Amps	Ohms Imped. 60Hz. (Ω)
6	12.84	64 lbs. 29 kg.	Gelled H <sub>2</sub> SO <sub>4</sub> SG = 1.300	800 Amps	2300 Amps @ 0.1 Sec.	11.2	0.0055 Ohms

<b>Capacity</b>	87 Ah @ 20 hour rate to 1.75 volts per cell @ 80°F (27°C)
<b>Operating Temperature Range</b>	<b>Discharge;</b> -40°F (-40°C) to + 160°F (71°C), <b>Charge;</b> -10°F (-23°C) to + 140°F (60°C) (with temperature compensation)
<b>Float Charging Voltage</b>	13.5 to 13.8 VDC/unit Average @ 77°F (25°C)
<b>Recommended Maximum Charging Current Limit</b>	C/5 amperes (17.2 amps @ 100% depth of discharge)
<b>Maximum AC Ripple (Charger)</b>	0.5% RMS or 1.5% P-P of float charge voltage recommended for best results Maximum AC ripple voltage allowed = 1.4% RMS (4% P-P) Maximum AC ripple current allowed = 4.3 amperes RMS (C/20)
<b>Self Discharge</b>	<b>BATRIC™ GEL/CELL</b> batteries may be stored for up to 6 months @ 77°F (25°C) and than a refreshing charge is required. For higher temperatures the time intervals will be shorter.
<b>Accessories</b>	Inter unit connectors, racks and cabinet systems are available
<b>Terminal</b>	<b>Threaded Copper alloy insert Terminal to accept 1/4-20 UNC Bolt</b>
<b>Terminal Hardware Initial Torque</b>	110 in. - lbs. (12.4 n – m)
<b>Terminal Hardware Annual Retorque</b>	110 in. - lbs. (12.4 n – m)

## Constant Current Discharge Ratings – Amperes @ 75°F (25°C) to 1.75 Volts per Cell

Amperes	5	10	15	20	25	30	35	40	45	50
Run Time (minutes)	1026	482	306	219	166	135	111	93	80	70

## Constant Current Discharge Ratings – Amperes @ 75°F (25°C)

Operating Time to End Point Voltage (In hours)

End Point Volts/Cell	.25	.50	1.00	2.00	3.00	4.00	5.00	6.00	7.00	8.00	10.00	12.00	20.00	24.00	48.00	72.00	100
1.75	137.7	91.9	55.9	32.8	23.5	18.4	15.3	12.9	11.45	10.0	8.20	6.90	4.30	3.70	1.90	1.30	0.90
1.80	127.5	88.3	54.7	32.2	23.0	18.0	15.0	12.7	11.12	9.94	8.11	6.81	4.29	3.60	1.86	1.29	0.88
1.85	113.7	80.7	51.1	30.7	22.1	17.3	14.5	12.3	10.8	9.53	7.80	6.61	4.09	3.50	1.80	1.25	0.86

**Note:** Batteries to be mounted with 0.5 in. (1.25 cm) spacing minimum and free air ventilation. Specifications subject to change without notification.

**BATRIC™**